

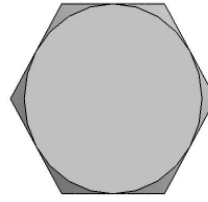

GRADES 2, 5 & 8

Carbon Steel Grades 1 through 8



GR2

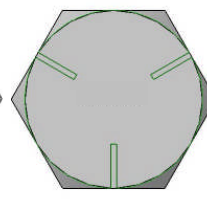

GR5

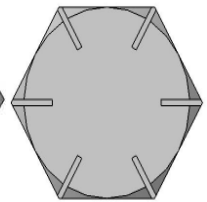

GR8

Chemical Requirements

Grade 2

Grade 5

Grade 8

- Carbon Min --- Max 0.55 Min 0.28 Max 0.55 Min 0.28 Max 0.55
- Phosphorous Min --- Max 0.05 Min --- Max 0.05 Min --- Max 0.04
- Sulfur Min --- Max 0.06 Min --- Max 0.06 Min --- Max 0.05

Mechanical Requirements

Grade 2

Grade 5

Grade 8

- Hardness Rockwell Min B70 Max B100 Min C19 Max C34 Min C33 MaxC39
- Tensile strength (KSI) Min 60 Max 74 Min 105 Max 120 Min 150 Max ---
- Proof Load (KSI) Min 33 Max 55 Min 74 Max 85 Min 120 Max ---
- Elongation 18 14 12

Hex Nuts Grade 2 ASTM A563 Hex Nuts Grade 5 ASTM A563 Hex Nuts Grade 8 ASTM A563

Black Plain Zinc Plated Hot Dip Galv FlourKote #1

Buried Submerged Above Grade Below Grade Other

Dimensional Data

- Unless otherwise specified, threads shall be the coarse thread series as specified in the latest issue of ANSI/ASME B1.1, page A-26.
- Having a class 2A tolerance.
- Bolts shall be hex bolts with dimensions as given in the latest issue of ANSI/ASME B 18.2.1, page C-1.
- Additional information can be found in SAE J429 and ASTM A563.